

DME&JDE GROUP
YOUR CONNECTORS & HOSES OEM SOLUTIONS



France Technology Equipment

DME&JDE



HOSE-CRIMPER GOLD GRADE

Hose-Crimper 140-ProMax

TECH Powered by:

SIEMENS

Schneider
Electric



Web: www.dmejde.com
E-Mail: info@dmejde.com



Tel: +86-318-6662021
Mobile: +86-19133858816 (WhatsApp & WeChat)

HOSE-CRIMPER GOLD GRADE

DME&JDE ©Hose-Crimper 140-ProMax

SIEMENS

Schneider Electric



Features

This is a gold grade equipment, because he can curl the maximum size is 4", the crimping equipment has high precision, fast speed, continuous production and other characteristics. All are operated by computer and touch screen, with real-time pressure display function, and can also use pressure deduction function. The machine is divided into two parts, and the PUMP has better heat dissipation and can work continuously for a long time.



► PLC Control System

- Jog
- Semi-automatic
- Cyclic Compression
- Rear Limit Buckle
- Segmented Detention
- Pressure Deduction
- Storage

Specification

► Technical Data

Compression Range (mm)	10-124
Maximum Clamping Force	3200
Number of Deductions (s)	2000
Hose Size (inches)	2½ - 4
Mold Stroke (mm)	+82
Min Button Pressing Die D/L (mm)	190/97
Maximum Opening Diameter(mm)	222
Motor Power (KW)	5.5/7.5
Fuel Tank Capacity (L)	120

► Dimensions (LxWxH)

Machine	1063 x 737 x 1589 mm
	41.9 x 29 x 62.6 inch
Package	1105 x 945 x 1890 mm
	43.5 x 37.2 x 74.4 inch
Station	713 x 705 x 1059 mm
	28.1 x 27.8 x 41.7 inch
Package	950 x 720 x 1340 mm
	37 x 28 x 52.5 inch

► Control

PLC

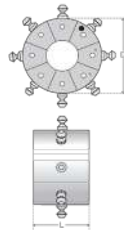

► Weight

Machine	875 N.W.
	1120 G.W.
Station	185 N.W.
	275 G.W.

► Advantage Summary

Rearview Mirror/Camera
Rear Limit
Foot Switch
Mold Replacement Handle

► Mold Model (P-32)

DieSeTNO	Crimping Range D	L (mm)
Die#06	6-8	55
Die#08	8-10	55
Die#10	10-12	55
Die#12	12-14	55
Die#14	14-16	55
Die#16	16-19	55
Die#19	19-22	70
Die#22	22-26	70
Die#26	26-30	70
Die#30	30-34	70
Die#34	34-39	75
Die#39	39-45	75
Die#45	45-51	90
Die#51	51-57	90
Die#57	57-63	100
Die#63	63-69	100
Die#69	69-74	100
Die#74	74-78	100
Die#78	78-87	100

► Mold Model (NO-140)

DieSeTNO	Crimping Range D	L (mm)
P 140/84	84-92	110
P 140/92	92-100	110
P 140/100	100-108	110
P 140/108	108-116	110
P 140/116	116-124	110
P 140/124	124-132	110
P 140/132	132-140	110

Web: <https://www.dmejde.com>
E-mail: info@dmejde.com